

Blindklinknageltang - Riveter - Blindnietgerät - Riveteuse

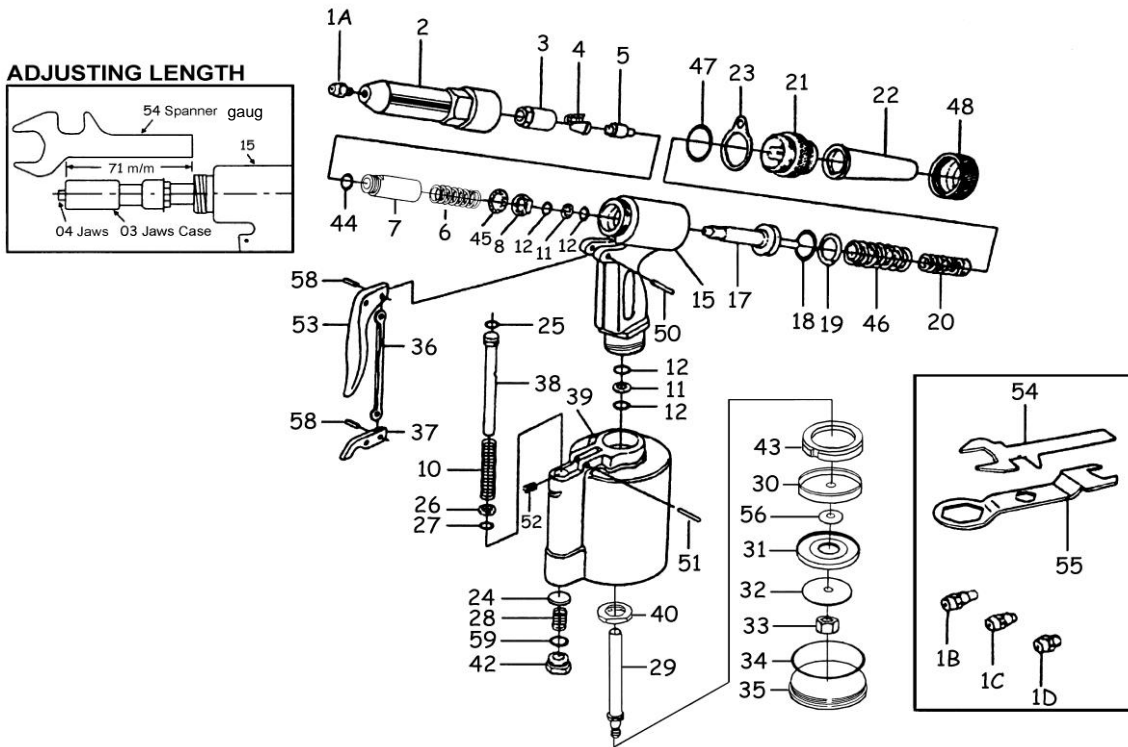

ITEM NO.	DESCRIPTION
1A	NOSE PIECE 4.8m/m (3/16")
1B	NOSE PIECE 4.0m/m (5/32")
1C	NOSE PIECE 3.2m/m (1/8")
1D	NOSE PIECE 2.4m/m (3/32")
2	NOSE HOUSING 87L
2L	LONG NOSE HOUSING 162L
3	JAWS CASE HEAD
4	JAWS "M" (5X10) (2)
5	JAW PUSHER
6	JAW PUSHER SPRING
7	JAW CASE BACK PART
7L	LONG JAW CASE BACK PART
8	JAW CASE LOCK NUT
10	VALVE PUSHER SPRING
11	B-RING P12
12	O-RING P12 (2)
15	FRAME
17	OIL PISTON
18	O-RING P22A
19	B-RING P22A
20	RETURN SPRING (INNER)
21	FRAME CAP
22	SAFETY CAP
23	HANGER CLIP
24	VALVE (DISC)
25	O-RING P7
26	COLLAR FOR VALVE PUSHER
27	O-RING P6
28	VALVE SPRING
29	AIR PISTON ROD

ITEM NO.	DESCRIPTION
30	BUMPER SET
31	CUP PACKING
32	PISTON WASHER
33	LOCK NUT
34	O-RING P.60
35	AIR CYLINDER CAP
36	TRIGGER CONNECTOR ROD
37	TRIGGER LEVER
38	VALVE PUSHER TUBE
39	AIR CYLINDER
40	FRAME LOCK NUT
42	NIPPLE END PLUG
43	BUMPER (RUBBER CUSHING)
44	O-RING
45	LOCK WASHER
46	RETURN SPRING (OUTER)
47	O-RING
48	SAFETY CAP NUT
50	SPRING PIN
51	SPRING PIN
52	LOCK SCREW
53	TRIGGER (LONG)
54	SPANNER GAUGE 15,14
55	SPANNER 24, 17, 10
56	PISTON WASHER SEAT
58	SPRING PIN
59	O-RING
60	UNIVERSAL JOINT(360°).0046A or B
61	OTHER THREAD JOINT PM20