

nÂ°	Artikel	Aantal gebruikt
*55	340899 STATOR SENSOR PCB SET 220-240 VOLT NEW	1
*85	500408Z CORD	1
*85	500424Z @ CORD FOR SINZ KUW	1
*85	500487Z CORD	1
*85	500453Z CORD	1
*85	930053 CORD	1
*85	500446Z CORD FOR GBR 230V	1
*85	500390Z CORD 5M 2 X 1.5 FOR HOL (NEW 714520)	1
*85	500488Z CORD (BRA)	1
*85	500467Z CORD FOR GBR 110 VOLT	1
*63	338182 CONTROLLER ASS'Y 100-127 VOLT NEW	1
*62	360992 ROTOR NEW	1
*85	500235Z CORD 5M 2 X 1.0 FOR EUROPE (NEW 714500)	1
*63	338183 CONTROLLER ASS'Y 220-240 VOLT NEW	1
*62	361015 ROTOR ASS'Y	1
*82	940778 CORD ARMOR D10.7	1
*71	338181 FILTER PCB SET 220-240 VOLT NEW	1
*82	958049 CORD ARMOR D8.2 (OLD 958049Z)	1
*71	338180 FILTER PCB SET 100-127 VOLT NEW	1
1	337562 FRONT CAP NEW JUL	1
2	318590 STOPPER RING	1
3	338155 RETAINER WASHER NEW	1
4	338154 GRIP NEW	1
5	339053 RETAINER DAMPER (A) NEW	1
6	338153 BIT LOCK HOLDER NEW	1
7	339051 THRUST PLATE NEW	1
8	339052 RETAINER SPRING NEW	1
9	337557 SPRING HOLDER (A) NEW JUL	1
10	872470 O-RING (S-26)	1
11	998471 HEX.SOCKET HD.BOLT M5X12	1
12	338120 CYLINDER CASE COVER NEW	1
13	318757 RETAINER RING D35	1
14	321839 RETAINING RING D62	1
15	6007DD BALL BEARING 6007DDUAV2S	1
16	321297 BEARING WASHER	1
17	321301 OIL SEAL 15Z 35X53X7	1
18	338121 CYLINDER CASE NEW	1
19	991712 HEX.SOCKET HD.BOLT (W/FLANGE)	4

nÂ°	Artikel	Aantal gebruikt
20	338142 O-RING (F) NEW	1
21	338124 RETAINER DAMPER HOLDER NEW	1
22	338123 RETAINER DAMPER (B) NEW	1
23	339047 DAMPER SLEEVE NEW	1
24	338122 RETAINER WASHER DAMPER NEW	1
25	337554 BIT LOCK	2
26	338125 RETAINER SLEEVE NEW	1
27	313057 NEEDLE PIN D6X6	4
28	324921 O-RING (C)	1
29	338126 SECOND HAMMER NEW	1
30	338127 DAMPER WASHER NEW	1
31	324923 DAMPER	1
32	338128 DAMPER HOLDER NEW	1
33	338129 CYLINDER NEW	1
34	338133 STRIKER NEW	1
36	338136 LOCK SPRING WASHER NEW	1
37	338130 SPRING HOLDER (B) NEW	1
38	338137 LOCK SPRING NEW	1
39	338135 LOCK SLEEVE NEW	1
40	338131 CLUTCH SPRING NEW	1
41	338132 CLUTCH NEW	1
42	338138 SLEEVE NEW	1
43	338157 SLIDER NEW	1
44	338139 METAL (A) NEW	1
45	338140 METAL WASHER NEW	1
46	338141 BEVEL GEAR NEW	1
47	338134 O-RING (E) NEW	1
48	338147 PISTON NEW	1
49	338149 PISTON PIN NEW	1
50	339049 CONNECTING ROD ASS'Y (OLD 338148) NEW	1
51	335303 NEEDLE BEARING	1
52	961501 HEX .HD. TAPPING SCREW D5X60	2
53	944954 BEARING WASHER	1
54	6201VV BALL BEARING 6201VVCMP2L	1
55A	340921 STATOR FET PCB SET 100-127 VOLT NEW	1
56	338168 HOUSING NEW	1
57	333225 DUST SEAL	1
58	338170 TAIL COVER NEW	1

nÂ°	Artikel	Aantal gebruikt
59	998485 HEX.SOCKET HD.BOLTM5X14 (W/FLANGE)	4
60	6202DD BALL BEARING 6202DDUCMPS2S (OLD 956937)	1
61	980700 DUST WASHER (B)	1
64	339056 RUBBER SHEET (C) NEW	1
65	339055 RUBBER SHEET (A) NEW	4
66	339057 RUBBER SHEET (D) NEW	1
67	338184 PANEL ASS'Y NEW	1
68	991690 SEAL LOCK HEX. SOCKET HD. BOLT M5X12	2
69	991711 DISTANCE PIECE (B)	2
70	338173 HANDLE (A) NEW	1
72	339058 FILTER PACKING NEW	1
73	310123 TRANSATORY UNIT	1
74	310124 HANDLE DAMPER	4
75	338162 HANDLE DAMPER HOLDER NEW	1
76	338176 BELLOWS NEW	1
77	337588 TRIGGER NEW	1
78	337587 SWITCH NEW JUN	1
79	338174 HANDLE (B) NEW	1
80	307028 TAPPING SCREW (W/FLANGE) D4X25 (BLACK)	5
81	958308Z PILLAR TERMINAL (A)	1
83	960266 CORD CLIP	1
84	984750 TAPPING SCREW (W/FLANGE) D4X16	2
86	338175 HANDLE SHAFT NEW	1
87	338197 BACK COVER NEW	1
88	994192 HEX.SOCKET HD.BOLT	4
89	NAME PLATE	1
90	338171 ON LOCK BUTTON NEW	1
91	338172 ON LOCK SPRING NEW	1
92	338185 ON LOCK PCB (A) ASS'Y NEW	1
93	339059 PACKING (A) NEW	1
94	330209 SIDE HANDLE	1
95	337577 WING BOLT NEW	1
97	338166 MOUNT NEW	1
98	949556 NUT M6 (10 PCS)	1
99	333227 HANDLE BOLT	1
100	338165 BAND NEW	1
101	949859 ROLL PIN D2X8 (10 PCS)	1
102	939540 RETAINING RING FOR D10 SHAFT (10 PCS.)	1

nÂ°	Artikel	Aantal gebruikt
103	338144 CRANK SHAFT NEW	1
104	971750 FEATHER KEY 3X3X20	1
105	948391 RETAINING RING FOR D40 HOLE	1
106	6203DD BALL BEARING 6203DDUCMAV2S	1
107	996363 O-RING (S-40)	1
108	878713 CYLINDER O-RING (B)	2
109	338191 WASHER NEW	2
110	338195 WEIGHT NEW	1
111	338179 ON LOCK PCB NEW	1
112	338192 WEIGHT PIN NEW	1
113	306061 SEAL LOCK HEX. SOCKET HD. BOLT M5	4
114	338193 LEAF SPRING (A) NEW	2
115	328906 SPRING HOLDER	2
116	338190 BASE NEW	1
117	338194 WEIGHT BUMPER NEW	2
118	990079 SEAL LOCK HEX. SOCKET HD. BOLT M5X16	2
119	339050 FELT PACKING (D) NEW	1
120	338161 CRANK COVER NEW	1
121	338177 HEX.SOCKET HD.BOLT M5X18 (W/FLANGE)	4
122	338159 CHANGE LEVER NEW	1
123	337567 LEVER SPRING NEW	1
124	959149 STEEL BALL D4.76 (10 PCS)	1
125	878885 O-RING (S-18)	1
126	338158 LEVER SHAFT HOLDER NEW	1
127	939547 RETAINING RING FOR D20 (10 PCS)	1
128	326257 O-RING (I.D. 74.5)	1
129	338156 CHANGE PLATE NEW	1
130	986940 SEAL LOCK HEX. SOCKET HD. BOLT M6X45	4
131	324544 FELT PACKING (B)	1
132	339048 VALVE NEW	1
133	339054 FELT PACKING (A) NEW	1
134	338143 CRANK CASE NEW	1
135	313050 OIL SEAL (A)	1
136	338178 SLIP CLUTCH ASS'Y NEW	1
137	338150 BEVEL PINION NEW	1
138	944109 FEATHER KEY 3X3X8	1
139	338151 COLLAR NEW	1
140	6002DD BALL BEARING 6002DDUCMPS2S	1

nÂ°	Artikel	Aantal gebruikt
141	313058 WASHER	1
142	313053 WASHER (A)	1
143	321281 GEAR HOLDER	1
144	320343 NEEDLE	10
145	321282 SPRING (C)	10
146	338152 SECOND GEAR NEW	1
147	321283 SPACER	1
148	629VVM BALL BEARING 629VVMC2EPS2L	1
149	944525 BEARING WASHER (C)	1
150	971745 OIL SEAL (A)	1
151	338145 FIRST GEAR NEW	1
152	338146 SECOND PINION NEW	1
153	939299 NEEDLE BEARING (M661)	1
154	338167 SEAL PACKING NEW	1
155	321313 SEAL LOCK HEX. SOCKET HD. BOLT M6X22	2
156	338169 GEAR COVER NEW	1
501	981840 GREASE (FG-6A) (30G)	1
502	339060 PLASTIC CARRYING CASE NEW OCT	1
503	971786 STOPPER ROD	1
601	308471 GREASE FOR HAMMER DRILL (70G)	1
602	980927 GREASE FOR IMPACT DRILL (FG-6A) (500G)	1
603	320859 SYRINGE (BLOW-OUT BULB TYPE)	1
604	318085 SYRINGE (BELLOWS TYPE)	1
605	313448 DRILL BIT (SDS MAX) D16X340	1
606	313456 DRILL BIT (SDS MAX) D16X540	1
607	313449 DRILL BIT (SDS MAX) D19X340	1
608	313457 DRILL BIT (SDS MAX) D19X540	1
609	313450 DRILL BIT (SDS MAX) D22X320	1
610	313458 DRILL BIT (SDS MAX) D22X520	1
611	313451 DRILL BIT (SDS MAX) D25X320	1
612	313459 DRILL BIT (SDS MAX) D25X520	1
613	313452 DRILL BIT (SDS MAX) D28X370	1
614	313460 DRILL BIT (SDS MAX) D28X570	1
615	313453 DRILL BIT (SDS MAX) D32X370	1
616	313461 DRILL BIT (SDS MAX) D32X570	1
617	313454 DRILL BIT (SDS MAX) D38X370	1
618	313462 DRILL BIT (SDS MAX) D38X570	1
619	313455 DRILL BIT (SDS MAX) D40X370	1

nÂ°	Artikel	Aantal gebruikt
620	313463 DRILL BIT (SDS MAX) D40X570	1
621	944460 TAPER SHANK DRILL BIT D11X100	1
622	944461 TAPER SHANK DRILL BIT D12.3X110	1
623	993038 TAPER SHANK DRILL BIT D12.7X110	1
624	944500 TAPER SHANK DRILL BIT D14.5X110	1
625	944477 COTTER	1
626	313465 ADAPTER (SDS MAX) FOR SDS PLUS SHANK BIT	1
627	955994 CORE BIT 25MM	1
628	955995 CORE BIT 29MM	1
629	955996 CORE BIT 32MM	1
630	955997 GUIDE PLATE (FOR CORE BIT 32MM)	1
631	955998 CORE BIT 35MM	1
632	955999 GUIDE PLATE (FOR CORE BIT 35MM)	1
633	956000 CORE BIT 38MM	1
634	956001 GUIDE PLATE (FOR CORE BIT 38MM)	1
635	955154 CORE BIT 45MM	1
636	955166 GUIDE PLATE (FOR CORE BIT 45MM)	1
637	955155 CORE BIT 54MM	1
638	955167 GUIDE PLATE (FOR CORE BIT 54MM)	1
639	956002 CORE BIT 64MM	1
640	956003 GUIDE PLATE (FOR CORE BIT 64MM)	1
641	955157 CORE BIT 79MM	1
642	955168 GUIDE PLATE (FOR CORE BIT 79MM)	1
643	956004 CORE BIT 94MM	1
644	956005 GUIDE PLATE (FOR CORE BIT 94MM)	1
645	955159 CORE BIT 105MM	1
646	955169 GUIDE PLATE (FOR CORE BIT 105MM)	1
647	313466 CORE BIT SHANK (B) SDS MAX D25-35	1
648	313467 CORE BIT SHANK (A) SDS MAX D38-150	1
649	956009 CENTER PIN (B) 147L FOR CORE BIT D32-35	1
650	955165 CENTER PIN (A) 133L FOR CORE BIT D38-150	1
651	321813 DRILL CHUCK 13VLD-D	1
652	313468 CHUCK ADAPTER (SDS MAX)	1
653	303334 CHUCK HANDLE	1
654	313469 CHEMICAL ANCHOR ADAPTER (SDS MAX) 12.7MM	1
655	313470 CHEMICAL ANCHOR ADAPTER (SDS MAX) 19MM	1
656	313471 BULL POINT (SDS MAX) 280L	1
657	313472 BULL POINT (SDS MAX) 400L	1

nÂ°	Artikel	Aantal gebruikt
658	313473 COLD CHISEL (SDS MAX) 280MM	1
659	313474 COLD CHISEL (SDS MAX) 400MM	1
660	313475 CUTTER (SDS MAX) W50X400L	1
661	313476 SCOOP (SDS MAX) 400L	1
662	313478 RAMMER (SDS MAX) 150MMX150MM	1
663	313477 BUSHING TOOL (SDS MAX)	1
664	313479 SHANK (SDS MAX)FOR RAMMER,BUSHING TOOL	1
665	956006 CORE BIT 120MM	1
666	956007 GUIDE PLATE (FOR CORE BIT 120MM)	1

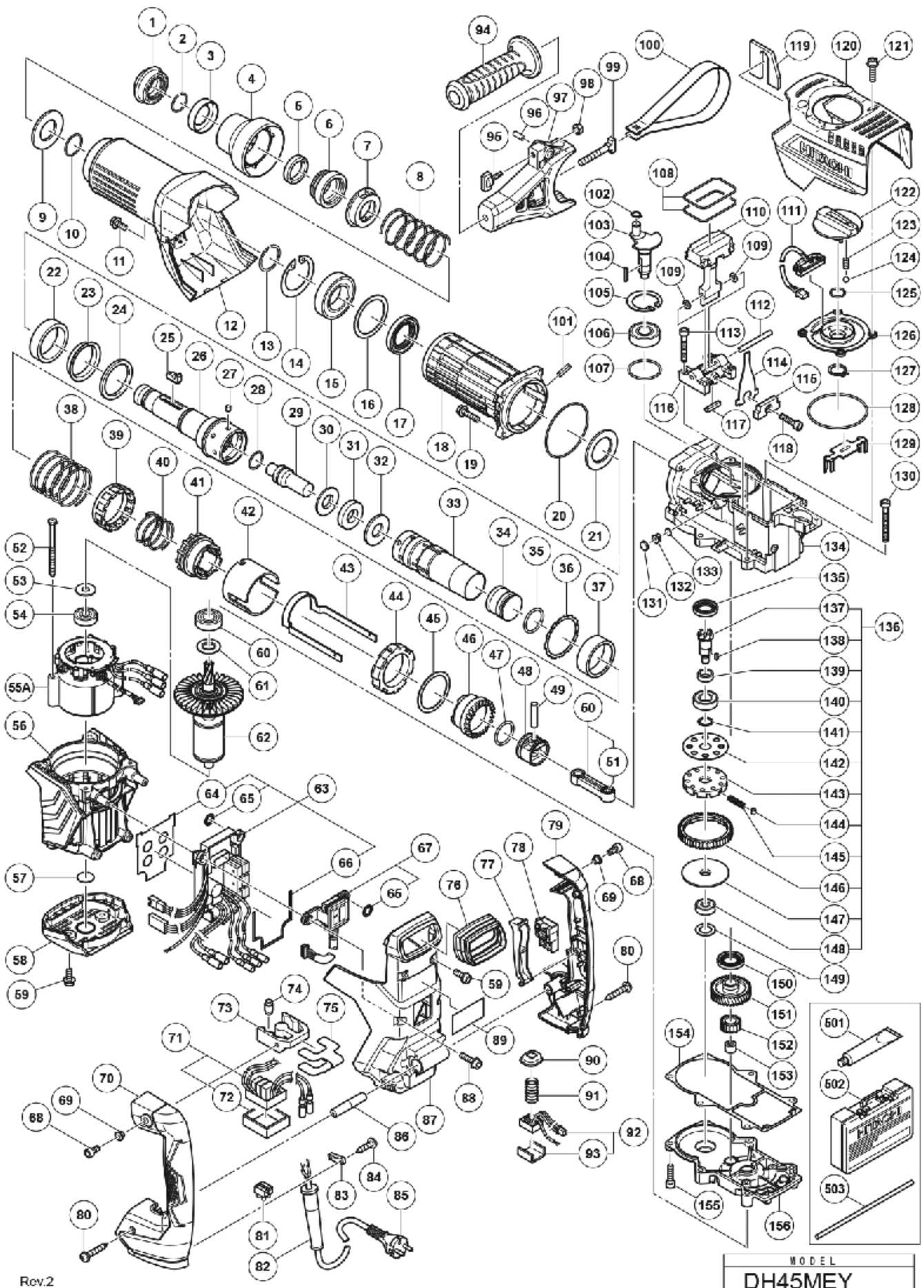

Rev.2

MODEL  
DH45MEY